

Ground Floor

Approx. 68.0 sq. metres (731.4 sq. feet)

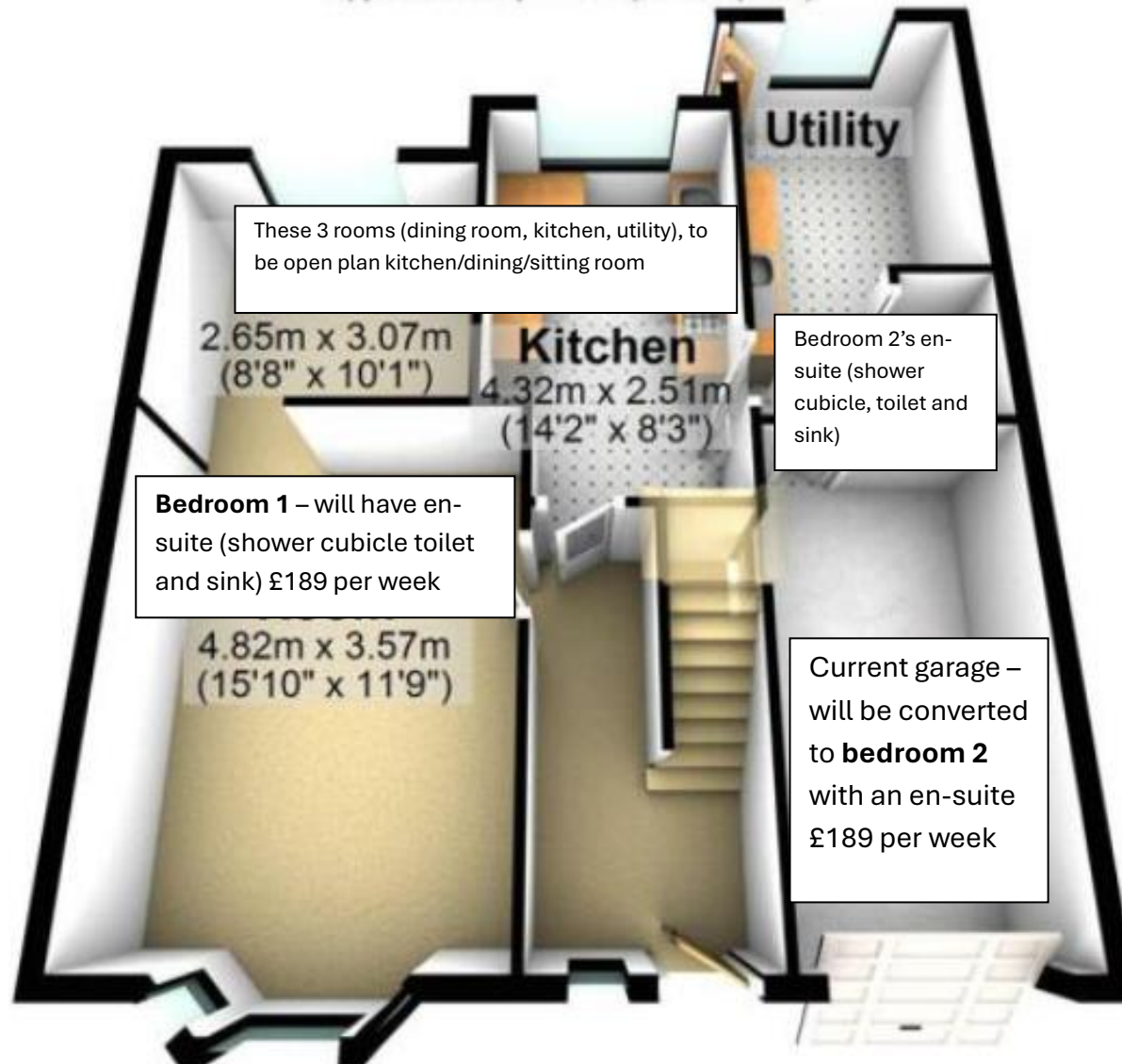

These 3 rooms (dining room, kitchen, utility), to be open plan kitchen/dining/sitting room

2.65m x 3.07m
(8'8" x 10'1")

Kitchen

4.32m x 2.51m
(14'2" x 8'3")

Utility

Bedroom 2's en-suite (shower cubicle, toilet and sink)

Bedroom 1 – will have en-suite (shower cubicle toilet and sink) £189 per week

4.82m x 3.57m
(15'10" x 11'9")

Current garage – will be converted to **bedroom 2** with an en-suite £189 per week

First Floor

Approx. 63.3 sq. metres (681.1 sq. feet)

