

28 Thief Lane

TOTAL AREA: 99.42 m² • LIVING AREA: 99.42 m² • FLOORS: 3

▼ Ground Floor

TOTAL AREA: 41.56 m² • LIVING AREA: 41.56 m² •

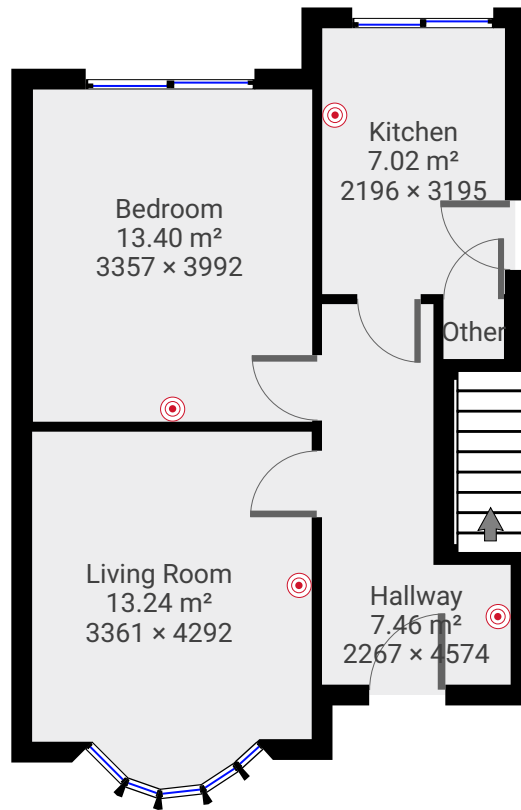

▼ 1st Floor

TOTAL AREA: 40.98 m² • LIVING AREA: 40.98 m² •

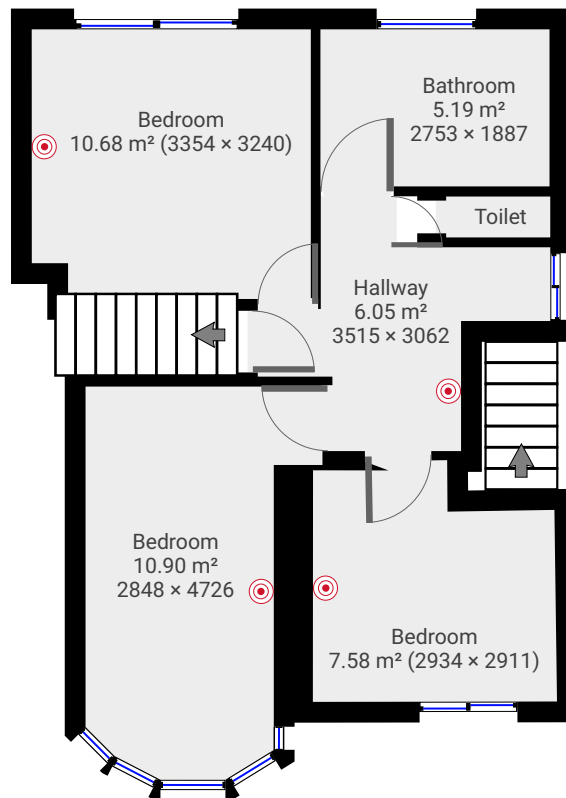

28 Thief Lane

TOTAL AREA: 99.42 m² • LIVING AREA: 99.42 m² • FLOORS: 3

▼ Roof

TOTAL AREA: 16.88 m² • LIVING AREA: 16.88 m² •

